



8 Westmount Drive South
Orillia, ON L3V 6C9
Tel: 705-327-0008
Fax: 705-327-0018
www.mariposaphysio.ca







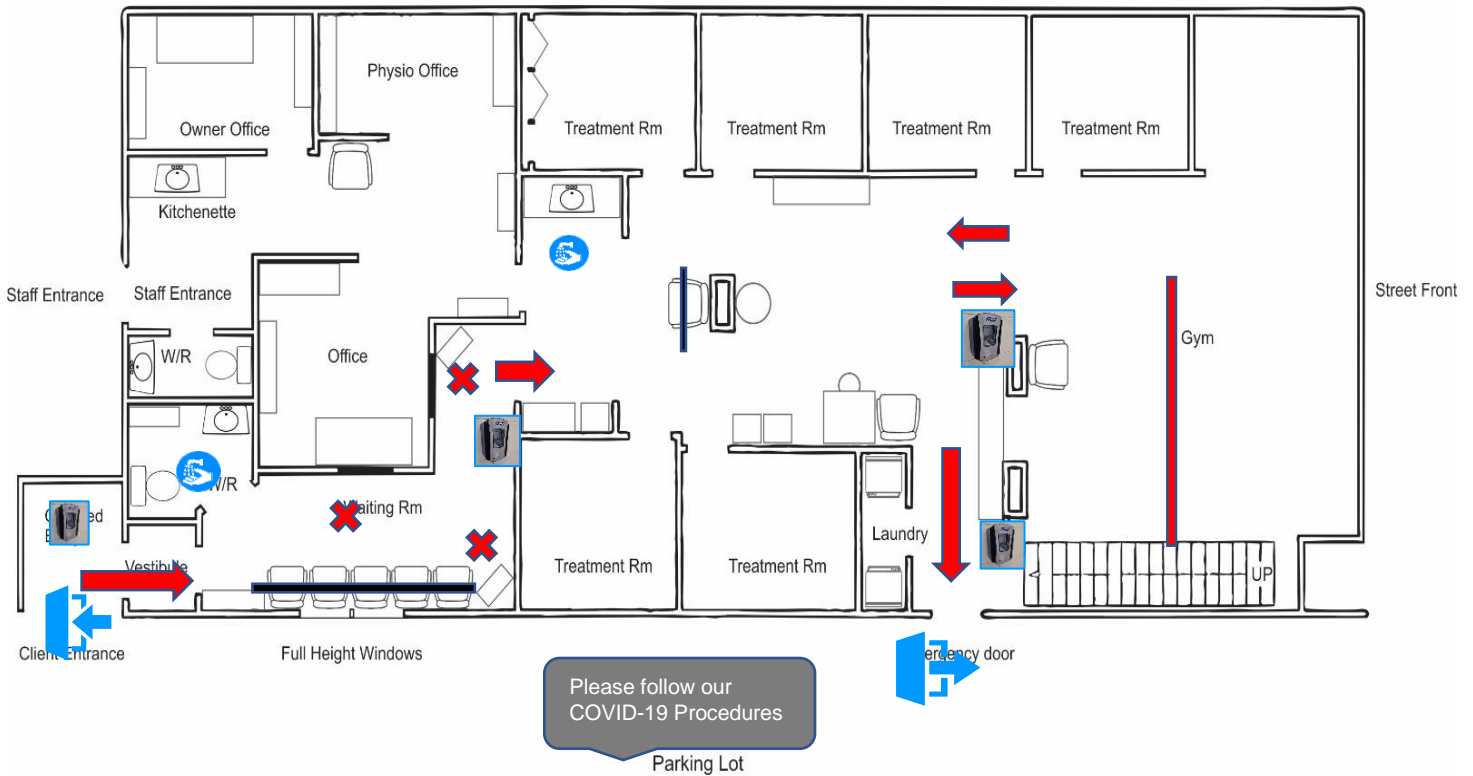

COVID-19 PROCEDURES TO KEEP YOU SAFE

- **Screening:** All staff and entrants are screened prior to booking/arrival and on entry to the clinic. We record all entrants to the clinic.
- **Cleaning and Disinfecting:** stringent practices completed after every entry/session of care at our clinic. All high touch areas cleaned at a higher frequency than recommended by Health Canada. Daily records kept with our procedures.
- **Hand Washing:** All entrants are asked to wash their hands both on entry and exit, and frequently while at the clinic. Several disinfecting stations are also available as well throughout the clinic to use and at the entry.
- **PPE** utilized by staff as per Ministry and College guidelines. All entrants must have a mask on to enter the clinic and remain on during your session.
- **Staff Training:** Proper PPE use, disinfecting procedures, hand washing, good hygiene practices and Screening protocol
- **Physical Distancing:** One-way entry and exit into and out of the clinic to avoid cross traffic and assist with social distancing; barriers up for staff; you will not be in contact with anyone except your therapist
- **Minimizing Contact:**
 - Paperless forms on our website: please complete & send back via email
 - Touchless payments available
 - Book your appointments on-line or by phone and avoid walk-ins
 - Please avoid bringing companions or extra items to the clinic
 - Reduced scheduling to allow for disinfecting between patients and minimized exposure to other people
- **Telerehabilitation** sessions continue to be available as an option of care

COVID-19 IN-CLINIC PROCEDURES AND LAYOUT



Legend

-  Where to stand and wait; ensuring more than 6.5 feet from another person
-  Arrows indicate direction of flow please follow them precisely
-  Indicates the dividing line in gym only one patient allowed on either side of the line, therapist must be supervising
-  Sink and soap available to wash your hands
-  Hand sanitization contactless stations, there are also multiple hand pumps throughout the waiting area and treatment rooms
-  An area that the equipment/furniture has been removed or blocked off and cannot be used
-  Exit Only
-  Entry Only